

583631-1 ✓ ACTIVE

AMP-LEAF | CGS HS

TE Internal #: 583631-1

Card Edge Connector Housings, Board-to-Board, 30 Position, .156 in [3.96 mm] Centerline, 30 Dual Positions, Printed Circuit Board, Power, CGS HS

[View on TE.com >](#)



Connectors > PCB Connectors > Card Edge Connectors > Card Edge Connector Housings

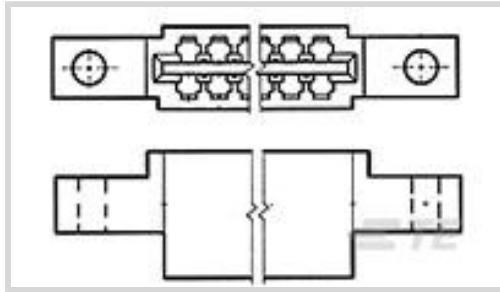

Connector System: **Board-to-Board**

Number of Positions: **30**

Centerline (Pitch): **3.96 mm [.156 in]**

Row-to-Row Spacing: **3.96 mm [.156 in]**

Number of Dual Positions: **30**

Features

Product Type Features

Connector System	Board-to-Board
Sealable	No
Connector & Contact Terminates To	Printed Circuit Board

Configuration Features

Number of Positions	30
Number of Dual Positions	30

Contact Features

Contact Current Rating (Max)	5 A
------------------------------	-----

Mechanical Attachment

Connector Mounting Type	Board Mount
-------------------------	-------------

Housing Features

Centerline (Pitch)	3.96 mm[.156 in]
--------------------	------------------

Dimensions

Row-to-Row Spacing	3.96 mm[.156 in]
--------------------	------------------

Usage Conditions

Operating Temperature Range	-55 – 105 °C[-67 – 221 °F]
-----------------------------	----------------------------

Operation/Application

Circuit Application

Power

Product Compliance

For compliance documentation, visit the product page on [TE.com](https://www.te.com)>

EU RoHS Directive 2011/65/EU

Compliant

EU ELV Directive 2000/53/EC

Compliant

China RoHS 2 Directive MIIT Order No 32, 2016

No Restricted Materials Above Threshold

EU REACH Regulation (EC) No. 1907/2006

Current ECHA Candidate List: JUNE 2022 (224)
Candidate List Declared Against: JAN 2019 (197)
Does not contain REACH SVHC

Halogen Content

Not Low Halogen - contains Br or Cl > 900 ppm.

Solder Process Capability

Not applicable for solder process capability

Product Compliance Disclaimer

This information is provided based on reasonable inquiry of our suppliers and represents our current actual knowledge based on the information they provided. This information is subject to change. The part numbers that TE has identified as EU RoHS compliant have a maximum concentration of 0.1% by weight in homogenous materials for lead, hexavalent chromium, mercury, PBB, PBDE, DBP, BBP, DEHP, DIBP, and 0.01% for cadmium, or qualify for an exemption to these limits as defined in the Annexes of Directive 2011/65/EU (RoHS2). Finished electrical and electronic equipment products will be CE marked as required by Directive 2011/65/EU. Components may not be CE marked. Additionally, the part numbers that TE has identified as EU ELV compliant have a maximum concentration of 0.1% by weight in homogenous materials for lead, hexavalent chromium, and mercury, and 0.01% for cadmium, or qualify for an exemption to these limits as defined in the Annexes of Directive 2000/53/EC (ELV). Regarding the REACH Regulation, the information TE provides on SVHC in articles for this part number is based on the latest European Chemicals Agency (ECHA) 'Guidance on requirements for substances in articles' posted at this URL: <https://echa.europa.eu/guidance-documents/guidance-on-reach>

Compatible Parts

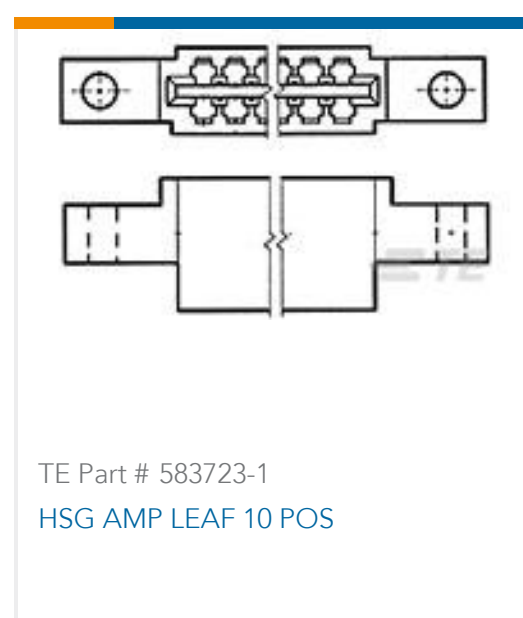

Also in the Series | **CGS HS**

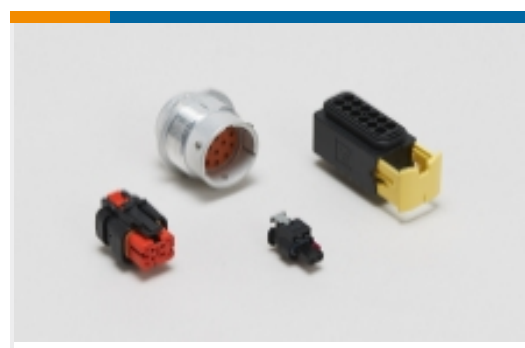

Automotive Housings(2)



Card Edge Connector Housings(2)



Chassis Mount Resistors(535)



FFC Connectors(1)



High Speed Backplane Connectors(11)

Plug & Socket Lighting Connector
Accessories(1)

RJ45 Connectors(1)

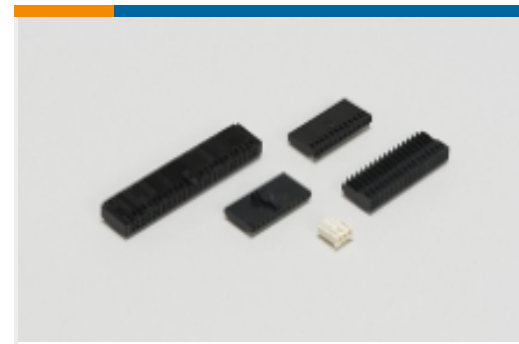
Wire-to-Board Connector Assemblies
& Housings(2)

Documents

Product Drawings

HSG AMP LEAF 30 POS

English

CAD Files

3D PDF

3D

Customer View Model

[ENG_CVM_CVM_583631-1_AB.2d_dxf.zip](#)

English

Customer View Model

[ENG_CVM_CVM_583631-1_AB.3d_igs.zip](#)

English

Customer View Model

[ENG_CVM_CVM_583631-1_AB.3d_stp.zip](#)

English

Customer View Model

[ENG_CVM_583631-1_S.3d_igs.zip](#)

English

Customer View Model

[ENG_CVM_583631-1_S.3d_stp.zip](#)

English

Customer View Model

[ENG_CVM_583631-1_S.2d_dxf.zip](#)

English

3D PDF



3D

By downloading the CAD file I accept and agree to the [Terms and Conditions](#) of use.

Product Specifications

Product Specification

English

[Connector, AMP-LEAF, .000030 Gold Plated Contacts, DPH Housing](#)

English

Product Specification

English

[Connector, AMP-LEAF, Phenolic or Thermoplastic Housing](#)

English

Product Specification

English

[Connector, AMP-LEAF, Tin Plated Contact](#)

English

Agency Approvals

Agency Approval Document

English